

Location of the Spring Forum sessions

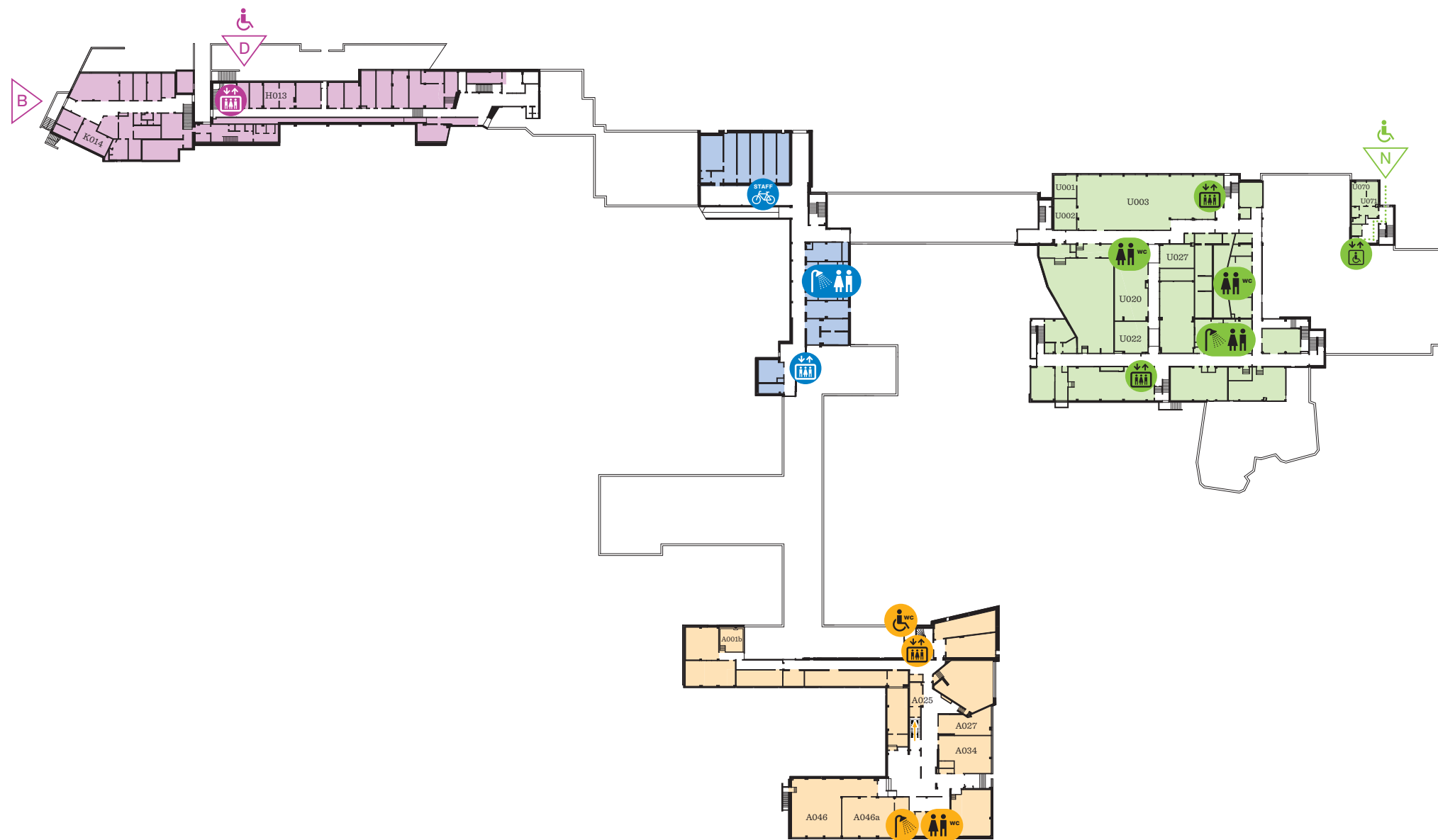

Location of the Spring Forum sessions

Metro / Lunch Food & Co A bloc – Otaniementie 12

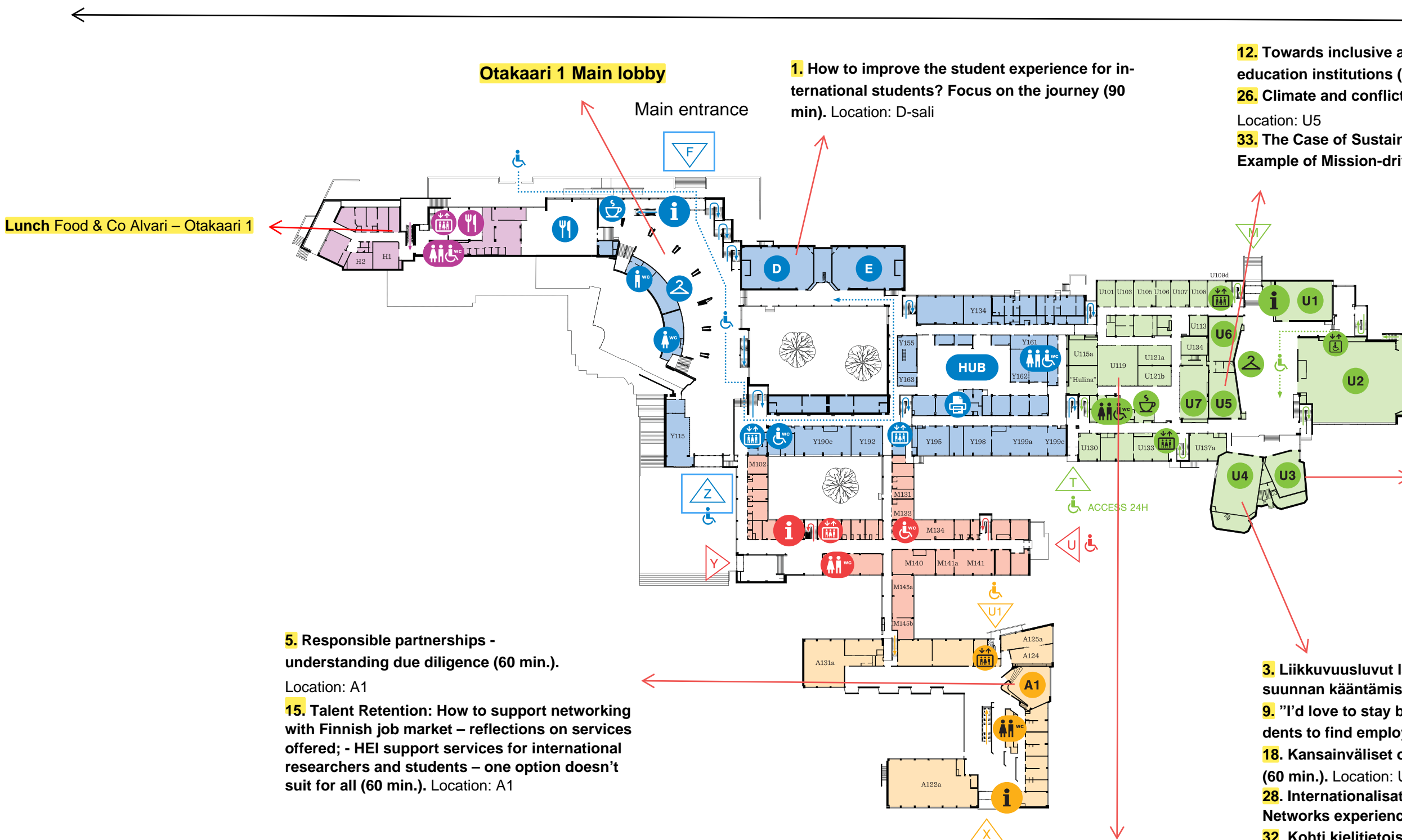

Otakaari 1 Main lobby

Main entrance

1. How to improve the student experience for international students? Focus on the journey (90 min). Location: D-sali

12. Towards inclusive and responsible language policies in higher education institutions (60 min.). Location: U5
26. Climate and conflicts – challenging global engagement (60 min.)? Location: U5
33. The Case of Sustainable Entrepreneurship for Climate Action as Example of Mission-driven Global Engagement (90 min.). Location: U5

Lunch Food & Co Alvari – Otakaari 1

2. Kuinka tunnistaa parhaat kansainvälisen opiskelijarekrytoinnin kohderyhmät (90 min). Location: U3
11. Rethinking funding schemes for responsible academic partnerships (60 min.). Location: U3
19. Korkeakoulujen globaalivastuullinen yhteistyö - fokuksessa Latinalainen Amerikka ja Karibia (60 min.). Location: U3
25. Go Green! - kohti vihreämpiä liikkuvuuksia (60 min.). Location: U3
34. Finnish HEIs co-creating foundations for responsible China cooperation (60 min.). Location: U3

5. Responsible partnerships - understanding due diligence (60 min.). Location: A1

15. Talent Retention: How to support networking with Finnish job market – reflections on services offered; - HEI support services for international researchers and students – one option doesn't suit for all (60 min.). Location: A1

3. Liikkuvuusluvut laskevat – mitä voimme yhdessä tehdä suunnan kääntämiseksi (90 min)? Location: U4
9. "I'd love to stay but..." - how can we help international art students to find employment in Finland (90 min.)? Location: U4
18. Kansainväliset opiskelijat Suomessa – ISB kyselyn tuloksia (60 min.). Location: U4
28. Internationalisation in transition – learning from the Global Networks experience (60 min.). Location: U4
32. Kohti kielitietoista korkeakoulu yhteisöä (90 min.). Location: U4

7. TALENT BOOST/SIMHE Bringing HEIs together through SIMHE (60 min.). Location: U119

27. Managing expectations and services at arrival stage. How to provide and deliver a matching set of services for incoming international staff and scholars arriving from risky conditions (60 min.)? Location: U119

29. Vastuullinen ja vastaanottava Suomi - yhdenvertaisuuden ja etnisen monimuotoisuuden edistäminen korkeakouluissa (90 min.). Location: U119

1 kerros
våning
floor

Location of the Spring Forum sessions

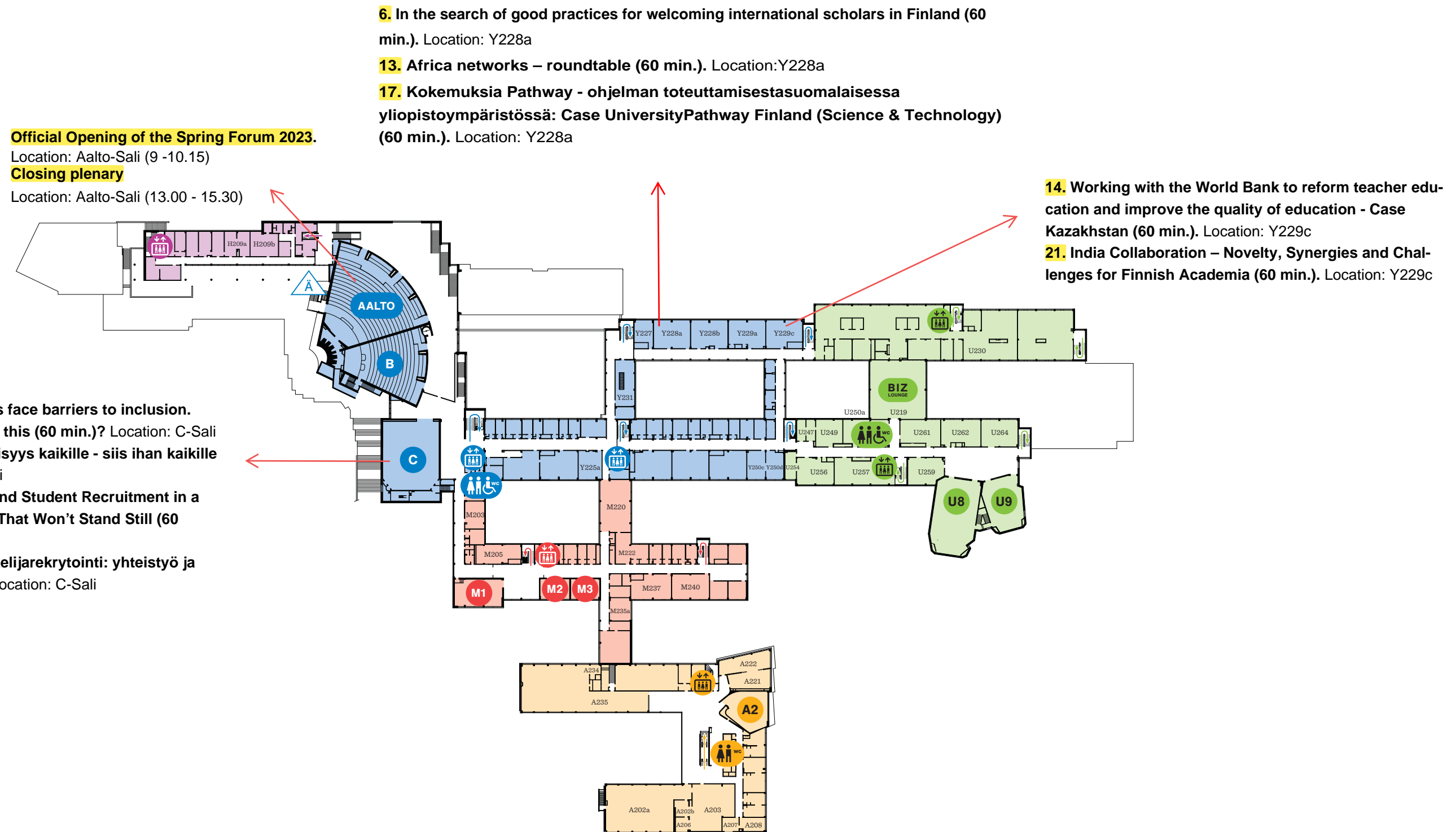

Location of the Spring Forum sessions

16. Diverse and inclusive work communities in higher education: how to get there (60 min.)? Location: H304

30. International Employability Landscape; student perspectives from Tampere (90 min.). Location: H304

23. Increasing the involvement of students, academics and societal partners in EUN-activities (60 min.). Location: Y307a

4. Unlocking the potentials of online learning for the internationalisation of higher education (60 min.). Location: Y313

8. Kansainvälisen akateemisen henkilöstön maahantulo prosessi sekä kaupungin/kunnan tuki kansainvälisten henkilöiden integraatiossa sekä pysyvyydessä. Puolisoverkoston merkitys (90 min.). Location: Y313

22. We want JYU – kansainvälisiä osajia kouk/luttamassa (60 min.). Location: Y313

35. TALENT BOOST/SIMHE Yliopistojen/korkeakoulujen valmentavat opinnot (60 min.). Location: Y313

