

AV touchpanel instructions



Show desktop



Show laptop



Show wireless

1 You can start the presentation using the short-cut buttons.

Be sure to switch on the external display of your PC.

If you are presenting audio aswell and are using the HDMI you will have to choose the right audio output in the control panel of your PC.

2 The system starts and will automatically begin the presentation.

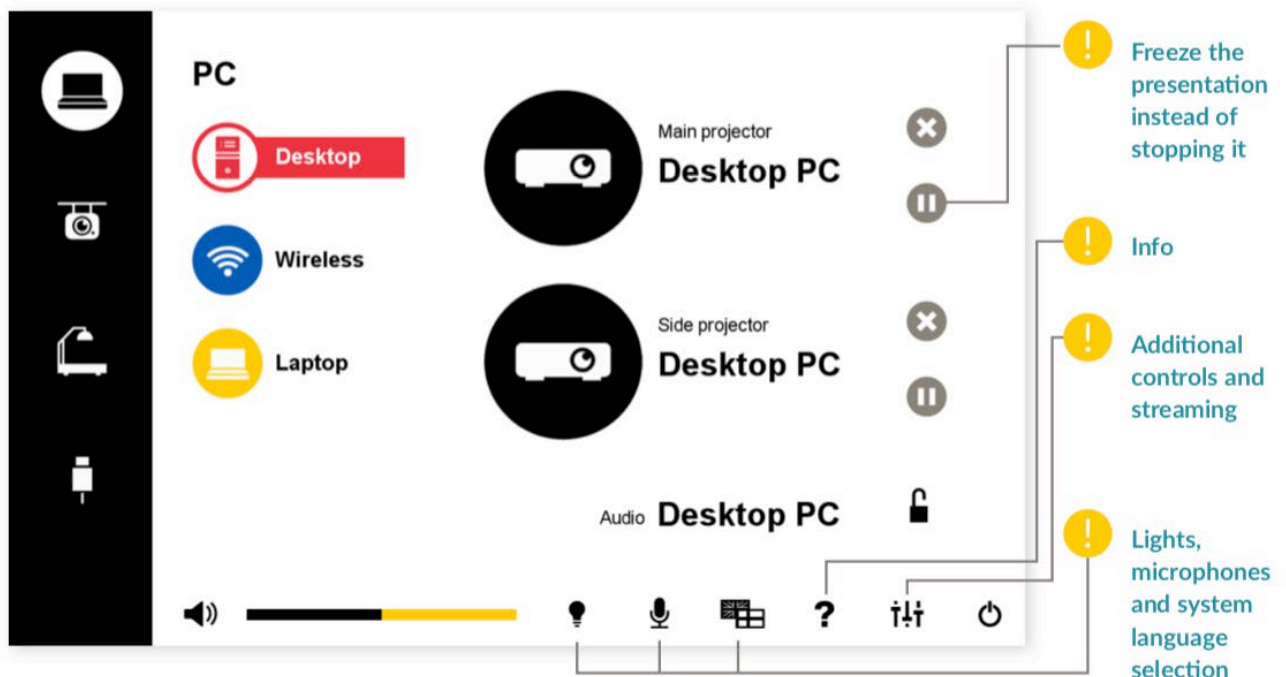

3 Stop the presentation by pressing the cross: 



Audio lock:

Closing the lock icon locks the current audio source on so that it will not change even if the image source does. Opening the lock releases the audio to follow the current source.



Switch off the system by pressing the 'off' button in the lower left corner when you finish the presentation.

You will also have to choose 'shutdown' when asked if you want to quit and shut down the system.

The AV equipment will then be switched off and the system resets.



Show wireless

VIA Collaboration quick start guide



1. **Connect** your device to Aalto or Aalto Open Wifi

2. **Download** the VIA Application (if not installed)

Win & Mac

- Enter the room name / IP address into your browser
- Select Run Via to download the application

Android & iOS

- Install the VIA App from Play Store / App Store
- You can also use this QR code



You can find the room name on the lower left of the main display screen.

3. **Run** the application and login using

- Room Name
- Room Code
- Your nickname

For security reasons the room code changes every 30 minutes.

With your mobile device you can also log in by QR scanning. Click the QR code icon on the lower right corner of the app and read the QR on the left corner of the screen. With QR login the room code authentication is bypassed.

4. Click **Present** button on your VIA application to start presenting. Once you have finished displaying your content, select **Stop Presenting** to remove your content from the display.

To access other available functions of the wireless collaboration system please select the Features tab on the application dashboard.

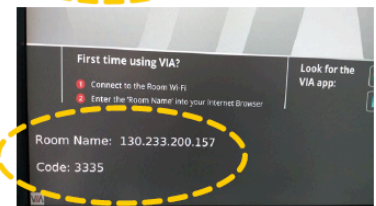
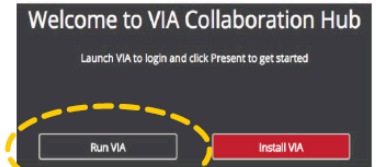

Welcome to VIA !

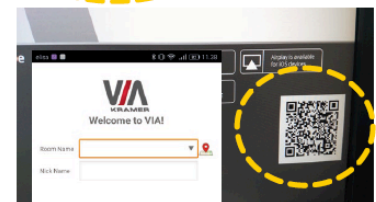
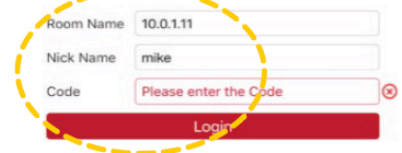

+ Two ways to **play video** from VIA:

File Searching Media Files

- Select "Multimedia" from features menu.
- Click Add Media in the lower left corner.
- Select and open a video you would like to add
- Doubleclick the media file to play the video

Drag/Drop Media directly to VIA

- Drag media file to the VIA logo on the lefthand side of the VIA dashboard. Once released, the video automatically starts playing